

AC POWER SUPPLY

PSH40AB10-EXT2

Enclosed Single 40 VA Power Supply, 120 to 24 Vac, with Three Foot Extension Cord

PSH100AB10-EXT2

Enclosed Single 100 VA Power Supply, 120 to 24 Vac, with Three Foot Extension Cord

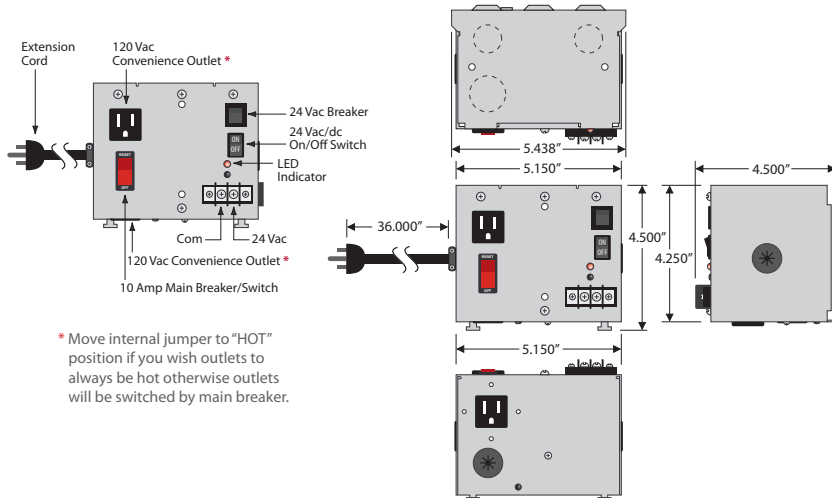

* Move internal jumper to "HOT" position if you wish outlets to always be hot otherwise outlets will be switched by main breaker.



PLUGS DIRECTLY INTO WIRED OUTLET BOX FOR USE ABOVE FALSE CEILINGS OR IN CONTROL PANELS

POWER SUPPLIES

SPECIFICATIONS

- Transformer:** One 40 VA (PSH40AB10-EXT2) or One 100 VA (PSH100AB10-EXT2)
- Over Current Protection:** Circuit Breaker
- Frequency:** 50/60 Hz
- 24 Vac ON/OFF:** On / Off Switch & Breaker
- Main Breaker ON/OFF:** Switch / Breaker (10 Amp) (Kills power to entire unit: Outlets, Aux. Output, & Transformer)*
Total Combined Output 9A
- Approvals:** Class 2 (UL Approved UL5085-3), UL916, C-UL
- Dimensions:** 4.500" x 5.438" x 4.500"
- Weight:** 4.00 lbs.

- Input Wires:** Powercord
BLK: 120 Vac
WHT: Neutral
GRN: Ground

- Output Wire:** Auxiliary Load Output
BLU: 120 Vac
9 Amp, max.

- Notes:**
 - Output derating may exceed 20% due to elevated ambient temperature or heat buildup in device over time.